

DRAWING MADE IN THIRD ANGLE PROJECTION

LOC	DIST	P	F	LTR	DESCRIPTION	DATE	APPROVED
AJ	16						
		✓	✓	O	-	-	-
		✓	✓	A	CHG DASH NO. 5	11/6/90	KH
		✓	✓	B	REV NOTES & TABLE	11/30/90	KH
					PR 90-3348-147		

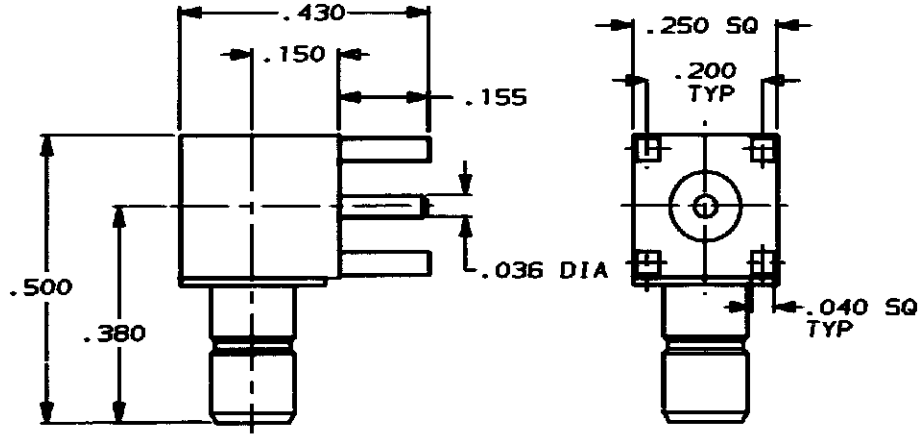

- MATERIALS:
 BODY...BRASS PER QQ-B-626
 CENTER CONTACT...
 BERYLLIUM COPPER PER
 QQ-C-530
 DIELECTRIC...TFE PER
 ASTM-D-1710

- FINISH:
 BODY, AND CENTER
 CONTACT...GOLD PER
 MIL-G-45204

- FINISH:
 BODY...NICKEL PER QQ-N-290
 CENTER CONTACT...
 GOLD PER MIL-G-45204

3	413996-4
2	413996-2
NOTES	PART NO

THIS DRAWING IS UNPUBLISHED. RELEASED FOR PUBLICATION BY AMP INCORPORATED. ALL INTERNATIONAL RIGHTS RESERVED. COPYRIGHT 19

DO NOT SCALE PRINT.
 UNLESS SPECIFIED
 DIMENSIONS IN INCHES
 TOLERANCES ON:
 2 PLC DEC ± .01
 3 PLC DEC ± .005
 ANGLES ± 1°

DR. *J. McLeod* 10/25/90
 CHK. J. McLEOD 11/6/90
 APPD. J. McLEOD 11/6/90
 APPD. K. HEILIG 11/30/90

AMP AMP Incorporated
 Harrisburg, PA 17105-3608

MATERIAL
 SEE NOTES

PRODUCT SPEC
 -

NAME
 JACK RCPT, MALE, RTANG, SMB/PCB

FINISH
 SEE NOTES

APPLICATION SPEC
 -
 WEIGHT -

SIZE A	CAGE CODE 00779	DRAWING NO 413996
SCALE NTS	SHEET 1 OF 1	

AMP 1-68-32 REV 11-89

CUSTOMER DRAWING